



1/45-49 Tinning Street Brunswick VIC

Vision Real Estate is delighted to offer this exceptional opportunity to launch your business from this strategically positioned premises.

- *Total building area of 58 sqm*
- *Outstanding position- 2 doors from Garrong Park.
- *Close to Anstey Train Station.
- *Grease trap plus provisions for exhaust flu.
- *Office use is also welcome.
- *Exclusive use of outdoor area.
- *Long lease available

For further information please contact Frank Romeo

* approximate

Price : Contact Frank Romeo
Building Size : 58 sqm
Land Size : 1 sqm
View : <https://www.visionrealestate.com.au/lease/vic/north/brunswick/commercial/retail/7951615>



Frank Romeo
03 9654 9800

45 Tinning Street, Brunswick

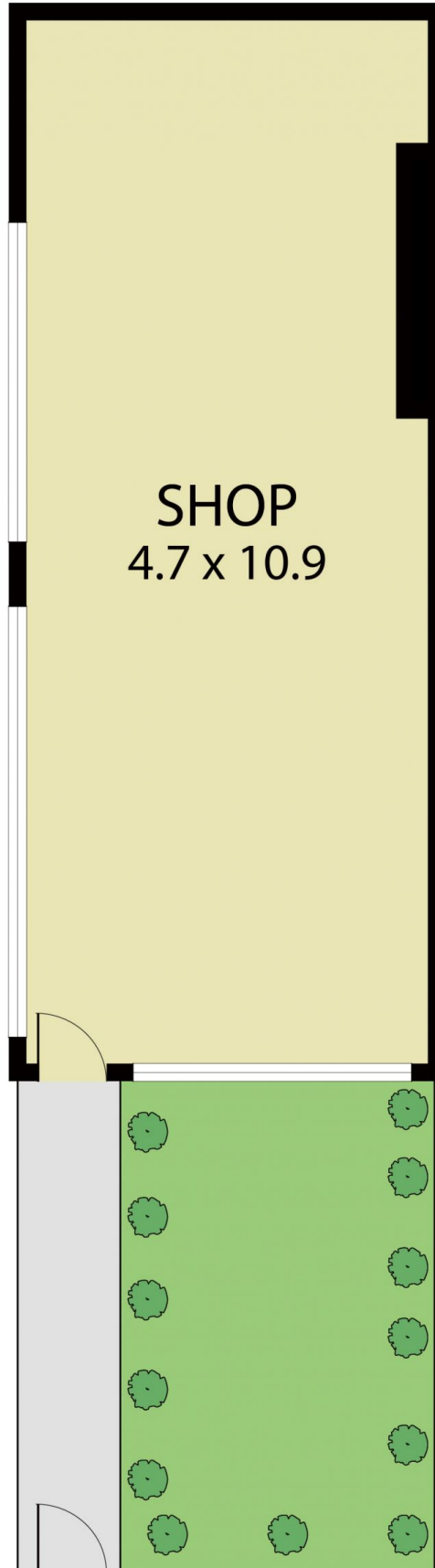

Disclaimer: Whilst we believe the contents of this document to be accurate, we suggest the prospective purchasers make any necessary enquiries to satisfy themselves. We do not accept responsibility for any errors or omissions.