



443 Nepean Highway Brighton East VIC

8 

Vision real estate is delighted to offer this magnificent main road opportunity firmly anchored by the surrounding national tenants.

- >HIGH PROFILE WAREHOUSE
- >FRONT & REAR VEHICLE ACCESS
- >FLANKED BY NATIONAL TENANTS

Price : \$5.75M plus GST
Land Size : 1153 sqm
View : <https://www.visionrealestate.com.au/sale/vic/bayside/brighton-east/commercial/industrial/7810738>

Sale Now - 443-447 Nepean Highway Brighton East

- *Strategic land offering of 543 sqm*to 1153 sqm*
- *Building areas from 374 sqm* to 785 sqm*
- *Prime Nepean Highway frontage plus additional rear right of way.
- *Popular Brighton East location joining the likes of JB Hi Fi, Land Rover, Dan Murphy, and Reece Plumbing.
- *Within close proximity to Bay St, Coles, North Brighton



Frank Romeo
03 9654 9800

443 Nepean Highway, Brighton East

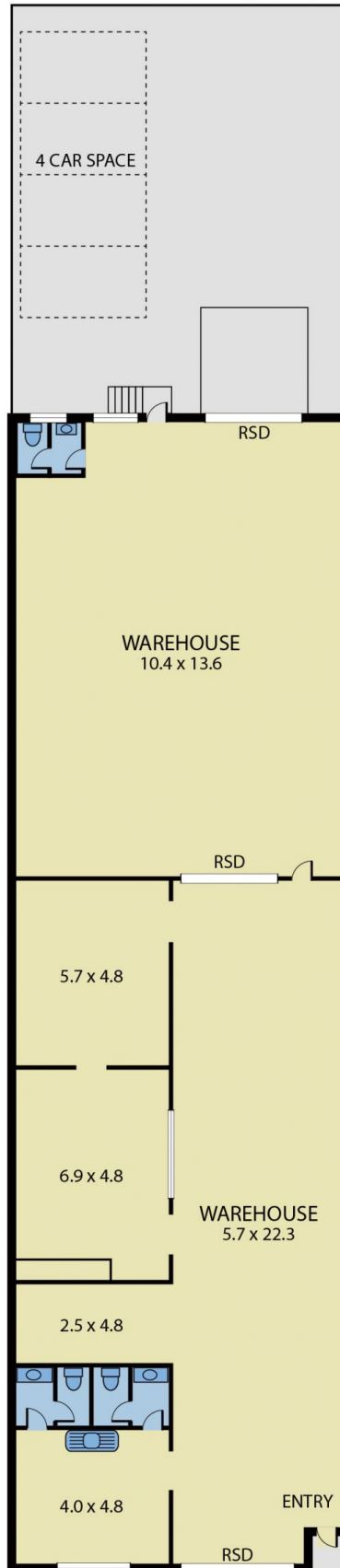

Disclaimer: Whilst we believe the contents of this document to be accurate, we suggest the prospective purchasers make any necessary enquiries to satisfy themselves. We do not accept responsibility for any errors or omissions.

445 Nepean Highway, Brighton East

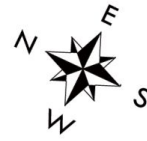
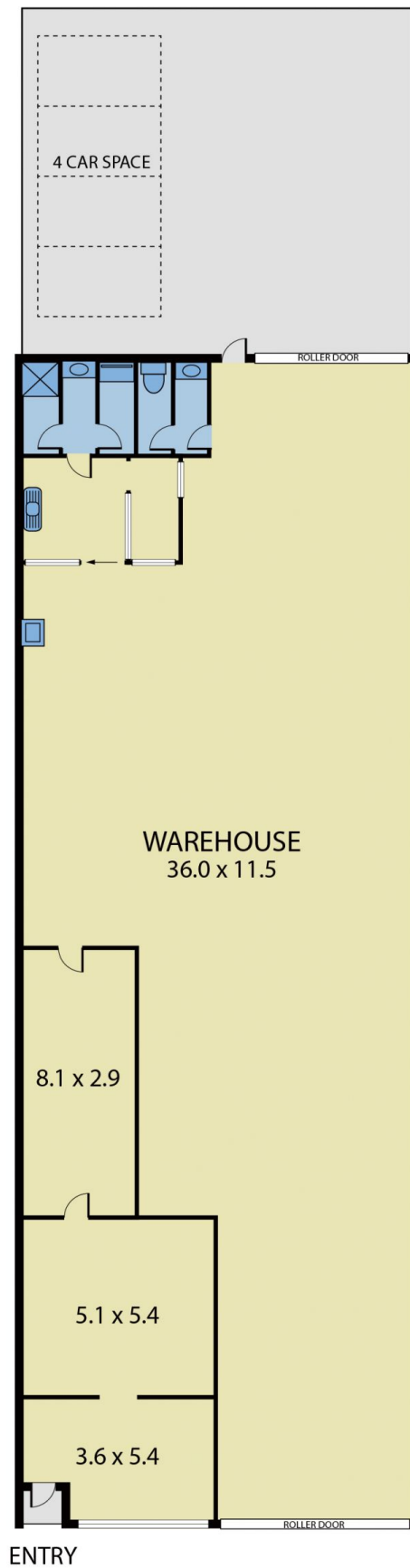

Disclaimer: Whilst we believe the contents of this document to be accurate, we suggest the prospective purchasers make any necessary enquiries to satisfy themselves. We do not accept responsibility for any errors or omissions.