

VISION

real estate



506 Queensberry Street North Melbourne VIC

2 

- > SHOP & DWELLING
- > TWO STREET FRONTAGES
- > OFFERED WITH A SHORT TERM TERM LEASE

Vision Real Estate is delighted to offer this magnificent two-level Victorian three bedroom shop and dwelling, ideally positioned close to the intersection of Errol St and Queensberry St in the ever so popular city fringe suburb of North Melbourne.

Key Features:

- *Total land area - 195 sqm*
- *Total building area over 2 levels - 165 sqm*

[For full version visit the website](https://www.visionrealestate.com.au)

Type : Retail
Price : \$1,695,000
Building Size : 165 sqm
Land Size : 195 sqm
View : <https://www.visionrealestate.com.au/sale/vic/inner-city/north-melbourne/commercial/retail/7751600>



Frank Romeo
02 9654 8888

<https://www.visionrealestate.com.au>

506 Queensberry St, North Melbourne

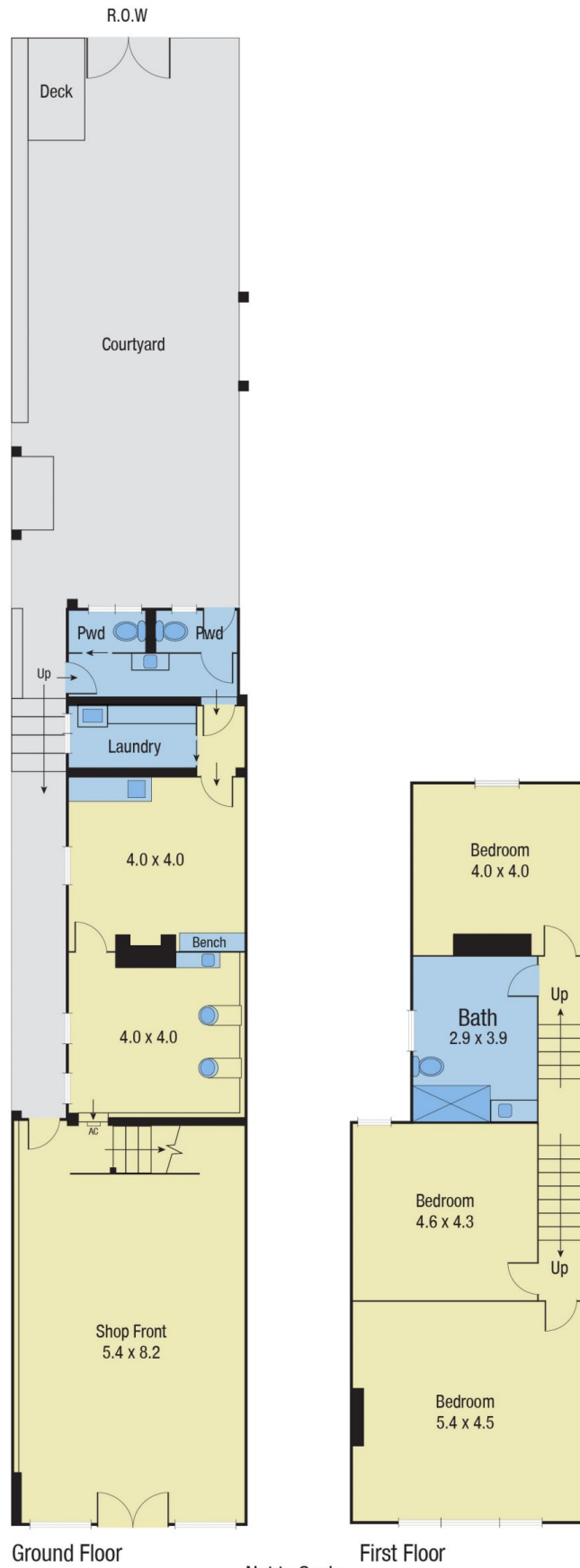

Not to Scale

Disclaimer: Every precaution has been taken to verify the accuracy of the above details.
However, prospective purchasers are advised to make their own enquiries.
We do not accept responsibility for any errors or omissions.