

## 252-254 Victoria Street Brunswick VIC

5 🚗

Vision real estate is delighted to offer this magnificent mixed use warehouse in one of Brunswick's most sought after locations all with walking distance to the lively Sydney Rd eateries and cafes.

### KEY POINTS:

- > Two Street Frontages
- > Occupy/Develop/Invest
- > Mixed Use Zone

\*Strategic land offering over two titles - 570 sqm\*

\*Modern concrete tilt panel construction delivering 536sqm\* of total building area over two levels plus usable mezzanine.

**Building Size** : 536 sqm  
**Land Size** : 579 sqm  
**View** : <https://www.visionrealestate.com.au/sale/vic/north/brunswick/commercial/industrial/7750286>



**Frank Romeo**  
03 9654 9800

# 252-254 Victoria Street, Brunswick

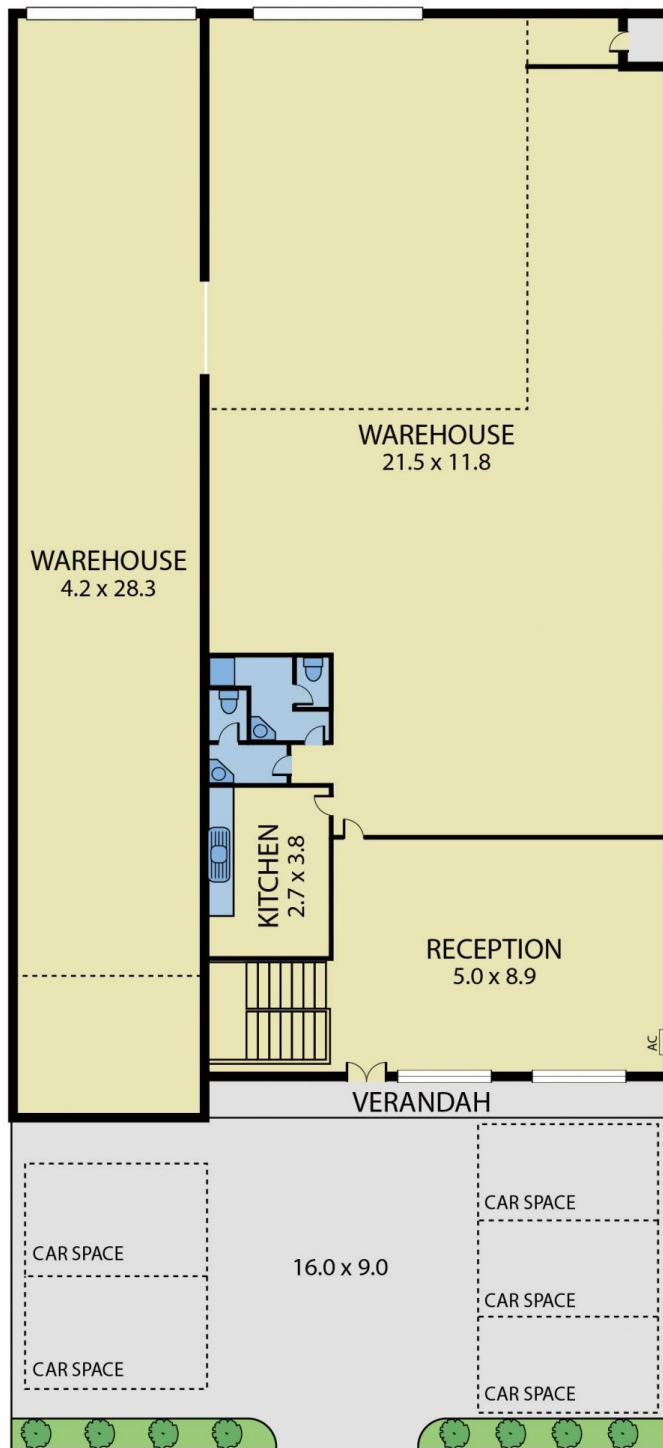

GROUND FLOOR

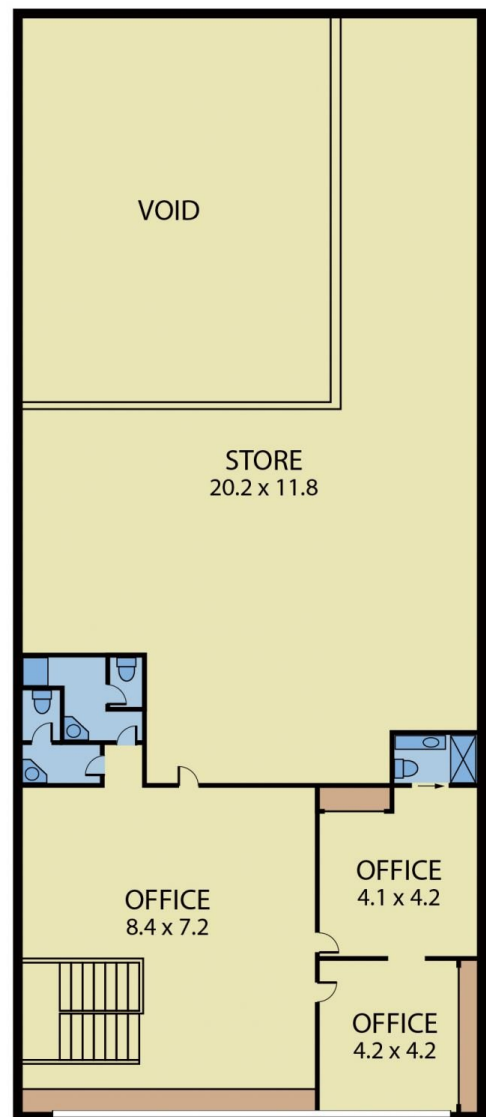

FIRST FLOOR



Disclaimer: Whilst we believe the contents of this document to be accurate, we suggest the prospective purchasers make any necessary enquiries to satisfy themselves. We do not accept responsibility for any errors or omissions.