



217-219 Main Street Lilydale VIC

- ? Building Area: 120sqm
- ? Excellent Corner position
- ? 2 car parks

Vision Real Estate are pleased to offer this rare opportunity to purchase this retail property located on one of the most prominent corners in Lilydale.

For Sale by Expressions of Interest closing Thursday 14th September at 2pm.

The opportunities;

Occupy - Perfect for the owner occupier and suitable for a multitude of uses. Offers a blank canvass to add value to.

Invest - Perfect entry level investment which was previously

Building Size : 120 sqm
View : <https://www.visionrealestate.com.au/sale/vic/east/lilydale/commercial/retail/7692854>



Tim Bindley
03 9654 9800

217-219 Main Street, Lillydale

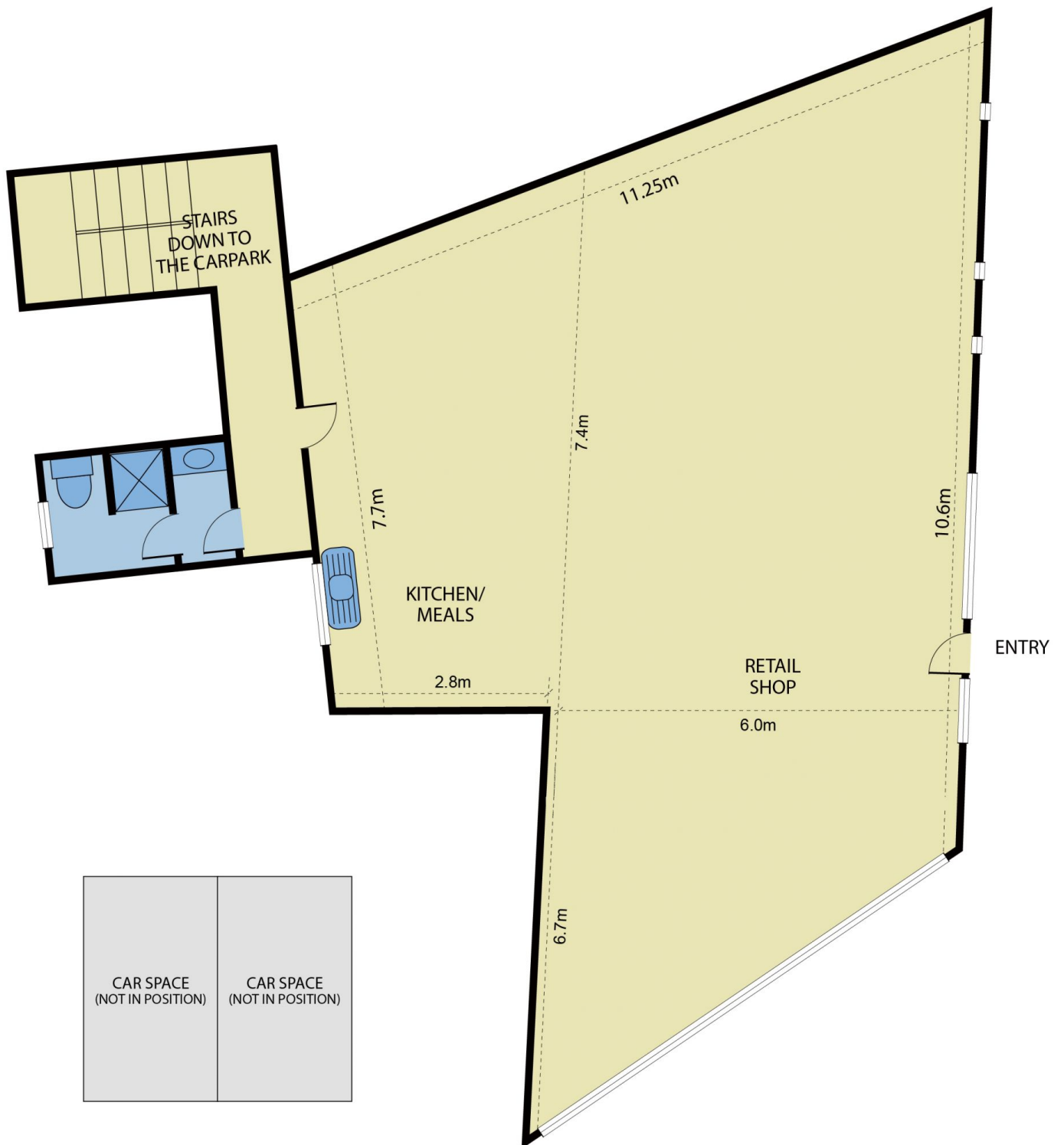

Not To Scale

Disclaimer: Whilst we believe the contents of this document to be accurate, we suggest the prospective purchasers make any necessary enquiries to satisfy themselves. We do not accept responsibility for any errors or omissions.