



**52/23-25 Gipps Street Collingwood VIC**

2 🚗

Vision Real Estate are pleased to offer this rare warehouse located at 52, 23-25 Glasshouse Road, Collingwood For Sale by Private Sale.

Located in one the hottest locations in inner city Melbourne, close to Smith Street shopping precinct and walking distance to trains, trams and busses and only minutes to the CBD.

Securely situated in the basement of "The Glassworks" this warehouse storage building has security like no other on the market.

Features Include;

**Type** : Industrial  
**Building Size** : 152 sqm  
**Land Size** : 152 sqm  
**View** : <https://www.visionrealestate.com.au/sale/vic/inner-city/collingwood/commercial/industrial/7558345>



**Tim Bindley**  
03 9654 9800

[For full version visit the website](https://www.visionrealestate.com.au)

# 52/23 Gipps Street, Collingwood

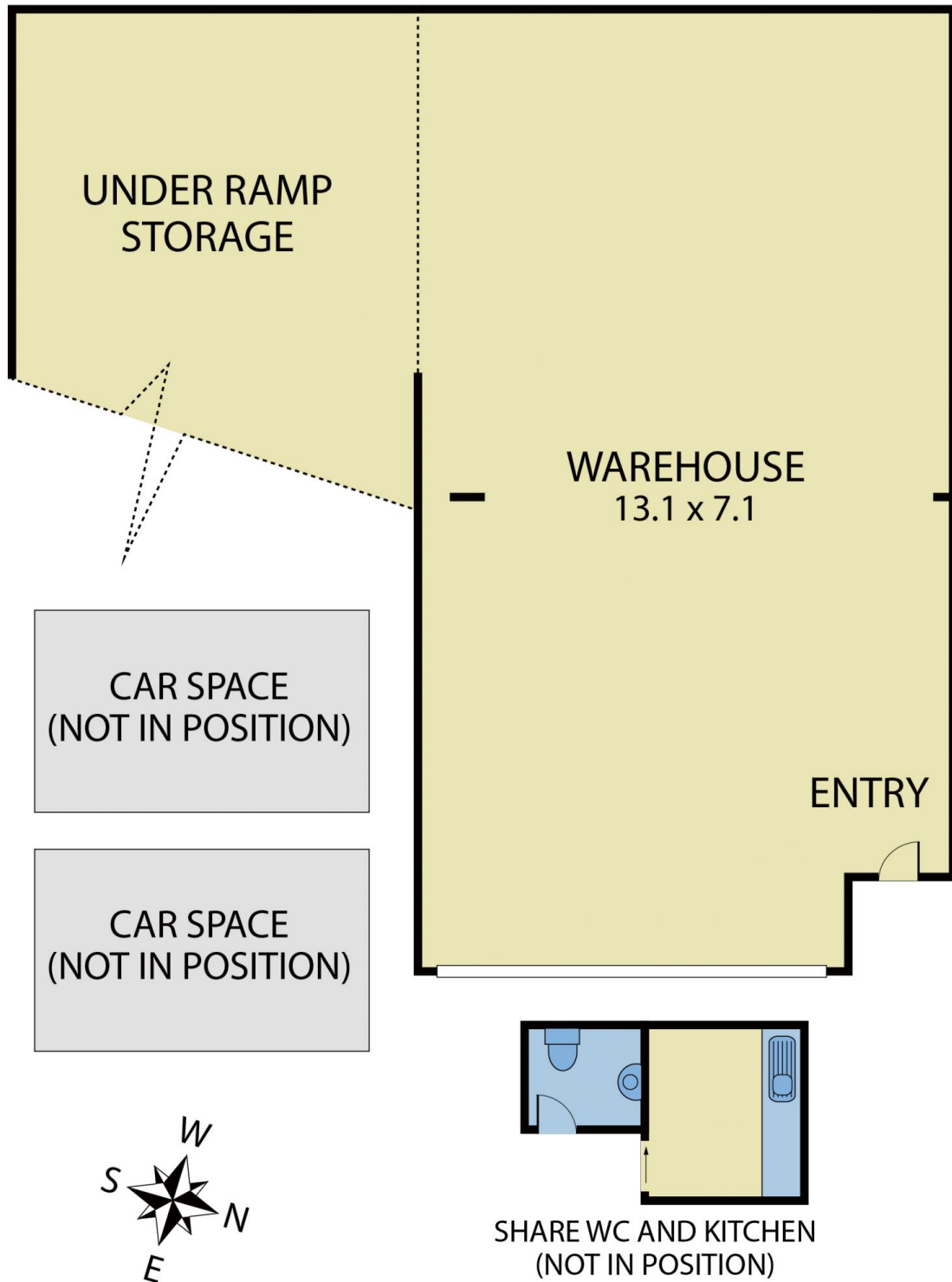

Not To Scale

Disclaimer: Whilst we believe the contents of this document to be accurate, we suggest the prospective purchasers make any necessary enquiries to satisfy themselves. We do not accept responsibility for any errors or omissions.