

445 & 447 Brunswick Street Fitzroy VIC

These ground floor retail investments represent an excellent opportunity to purchase secure retail investments in Melbourne's popular and well known inner city retail precinct of Brunswick Street, Fitzroy.

445 BRUNSWICK STREET, FITZROY

Tenant: Patel's Pharmacy
Lease terms: 5 + 5 + 5
Rent: \$35,000 pa + GST and outgoings
Building area: 103m²
Land area: 175m²
Private rear courtyard

447 BRUNSWICK STREET, FITZROY

Tenant: Cricket Kit
Lease terms: 4 + 2 + 2
Rent: \$35,800 pa + GST and outgoings

Building Size : 105 sqm
Land Size : 175 sqm
View : <https://www.visionrealestate.com.au/sale/vic/inner-city/fitzroy/commercial/retail/7420358>



James Doherty
0401221318

447 Brunswick Street, Fitzroy

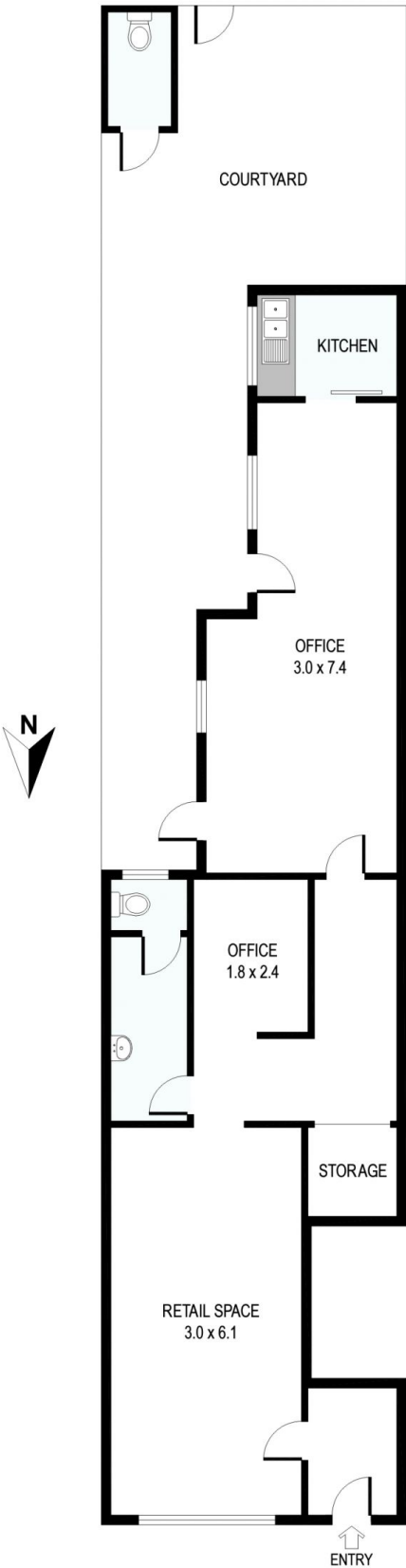

Please note: All stated dimensions are approximate only. Particulars given are for general information only and do not constitute any representation on the part of the vendor or agent.

